

SV 7mmL, Long Life Assurance
series

- Extended load life of 5000 hours at +105°C, with 7mm height.
- Adapted to the RoHS directive (2002/95/EC).

ST Long Life → SV

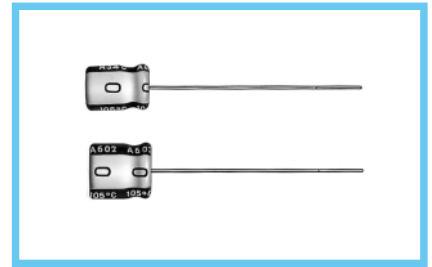

■ Specifications

Item	Performance Characteristics	
Category Temperature Range	-40 to +105°C	
Rated Voltage Range	6.3 to 50V	
Rated Capacitance Range	0.1 to 220μF	
Capacitance Tolerance	±20% at 120Hz, 20°C	
Leakage Current	After 2 minutes' application of rated voltage, leakage current is not more than 0.01CV or 3(μA), whichever is greater.	
tan δ	Measurement frequency : 120Hz, Temperature : 20°C	
	Rated voltage (V)	6.3 10 16 25 35 50
	tan δ (MAX.)	0.24 0.21 0.18 0.15 0.13 0.12
Stability at Low Temperature	Measurement frequency : 120Hz	
	Rated voltage (V)	6.3 10 16 25 35 50
	Impedance ratio Z-25°C / Z+20°C	4 3 2 2 2 2
	ZT / Z20 (MAX.)	Z-40°C / Z+20°C 8 6 4 3 3 3
Endurance	After 5000 hours' application of rated voltage at 105°C, capacitors meet the characteristic requirements listed at right.	
	Capacitance change	Within ±30% of initial value
	tan δ	300% or less of initial specified value
	Leakage current	Initial specified value or less
Shelf Life	After storing the capacitors under no load at 105°C for 1000 hours, and after performing voltage treatment based on JIS C 5101-4 clause 4.1 at 20°C, they will meet the specified value for endurance characteristics listed above.	
Marking	Printed with silver color letter on dark brown sleeve.	

■ Radial Lead Type

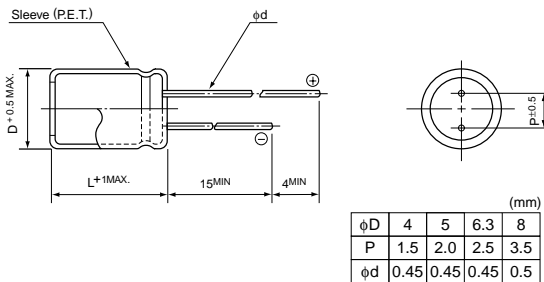

Type numbering system (Example: 10V 33μF)

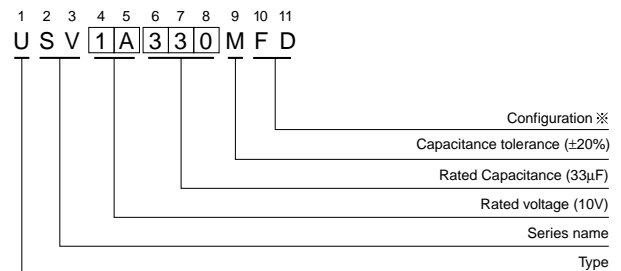

※ Configuration	
φ D	Pb-free leadwire Pb-free PET sleeve
4 to 8	FD

■ Dimensions

V		6.3	10	16	25	35	50
Cap.(μF)	Code	0J	1A	1C	1E	1V	1H
0.1	0R1						4 × 7 1.0
0.22	R22						4 × 7 2.3
0.33	R33						4 × 7 3.5
0.47	R47						4 × 7 5.0
1	010						4 × 7 10
2.2	2R2						4 × 7 19
3.3	3R3						4 × 7 24
4.7	4R7					4 × 7 24	5 × 7 29
10	100			4 × 7 29	5 × 7 33	5 × 7 36	6.3 × 7 44
22	220	4 × 7 34	5 × 7 38	5 × 7 44	6.3 × 7 51	6.3 × 7 57	8 × 7 65
33	330	5 × 7 42	5 × 7 47	6.3 × 7 57	6.3 × 7 63	8 × 7 72	
47	470	5 × 7 50	6.3 × 7 59	6.3 × 7 68	8 × 7 78		
100	101	6.3 × 7 77	8 × 7 96	8 × 7 107			
220	221	8 × 7 130					Case size φD × L (mm)
							Rated ripple

Rated Ripple (mArms) at 105°C 120Hz

● Frequency coefficient of rated ripple current

Frequency	50 Hz	120 Hz	300 Hz	1 kHz	10 kHz or more
Coefficient	0.70	1.00	1.17	1.36	1.50

Please refer to page 20, 21, 22 about the formed or taped product spec.
Please refer to page 4 for the minimum order quantity.

CAT.8100W