

Alchip®-MVK Series

- Endurance : 105°C 1000 to 2000 hours
- Suitable to fit for downsized equipment
- Solvent-proof type (see PRECAUTIONS AND GUIDELINES)

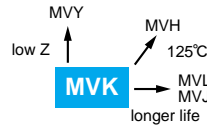

◆SPECIFICATIONS

Items	Characteristics								
Category	-40 to +105°C								
Temperature Range	-40 to +105°C								
Rated Voltage Range	6.3 to 50V _{dc}								
Capacitance Tolerance	±20% (M) (at 20°C, 120Hz)								
Leakage Current	I=0.01CV or 3μA, whichever is greater. (at 20°C after 2 minutes)								
Dissipation Factor (tanδ)	Rated voltage (V _{dc})	6.3V	10V	16V	25V	35V	50V		
	tanδ (Max.)	D55 to F55	0.30	0.24	0.20	0.16	0.14	0.12	(at 20°C,120Hz)
Low Temperature Characteristics (Max. Impedance Ratio)	Rated voltage (V _{dc})	6.3V	10V	16V	25V	35V	50V		
	Z(-25°C)/Z(+20°C)	4	3	2	2	2	2		
	Z(-40°C)/Z(+20°C)	10	8	6	4	3	3	(at 120Hz)	
Endurance	The following specifications shall be satisfied when the capacitors are restored to 20°C after the rated voltage is applied for the specified period of time at 105°C.								
	Case code	D55 to F55			H63 to J10				
	Time	1000hours			2000hours				
	Capacitance change	≤±30% of the initial value			≤±20% of the initial value				
	D.F. (tanδ)	≤300% of the initial specified value			≤200% of the initial specified value				
	Leakage current	≤The initial specified value			≤The initial specified value				
Shelf Life	The following specifications shall be satisfied when the capacitors are restored to 20°C after exposing them for the specified time at 105°C without voltage applied.								
	Case code	D55 to F55			H63 to J10				
	Time	500hours			1000hours				
	Capacitance change	≤±25% of the initial value			≤±20% of the initial value				
	D.F. (tanδ)	≤200% of the initial specified value			≤200% of the initial specified value				
	Leakage current	≤The initial specified value			≤The initial specified value				

◆DIMENSIONS (Terminal Type=VC) [mm]

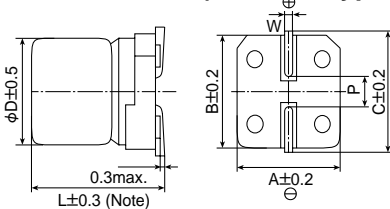

Case code	D	L	A	B	C	W	P
D55	4	5.2	4.3	4.3	5.1	0.5 to 0.8	1.0
E55	5	5.2	5.3	5.3	5.9	0.5 to 0.8	1.4
F55	6.3	5.2	6.6	6.6	7.2	0.5 to 0.8	1.9
H63	8	6.3	8.3	8.3	9.0	0.5 to 0.8	2.3
H10	8	10.0	8.3	8.3	9.0	0.7 to 1.1	3.1
J10	10	10.0	10.3	10.3	11.0	0.7 to 1.1	4.5

Note : L±0.5 for H63, H10 and J10

◆MARKING

EX) 6.3V100μF



◆PART NUMBERING SYSTEM

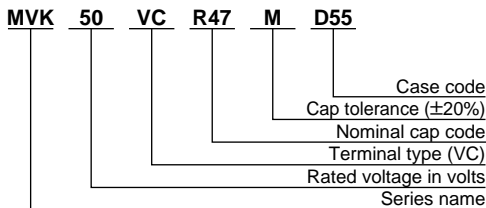

Capacitance	Code
0.1μF	R1
0.47μF	R47
1.0μF	1
4.7μF	4R7
10μF	10
100μF	100
1000μF	1000

◆STANDARD RATINGS

μF	6.3		10		16		25		35		50	
0.1											D55	1.3
0.22											D55	2.6
0.33											D55	3.2
0.47											D55	3.8
1.0											D55	5.6
2.2											D55	10
3.3											D55	14
4.7											E55	19
10											D55	29
22	D55	21			D55	16			E55	25	F55	29
33					E55	30			F55	40	H63	70
47	E55	36							H63	80	H10	140
100	F55	56	H63	90					H10	180	J10	170
220			H10	180								310
330	H10	290							J10	450		
470												
1000	J10	410			J10	460						

Note : → Use next higher voltage part.