

RECOMMENDED P.C. BOARD  
HOLE PATTERN  
FOR STRAIGHT PINS.

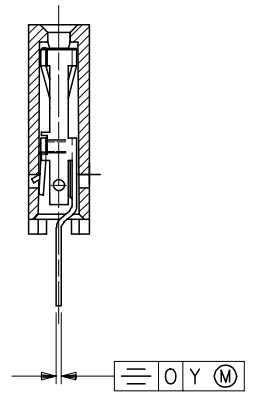

SECTION C-C SHOWING  
STRAIGHT PINS.

NOTES:

- 1) CONTACT-PLATED PHOSPHOR BRONZE.
- 2) HOUSING-15% GLASS FILLED POLYESTER. COLOUR: BLACK.
- 3) FOR (0.635)/.025 SQ. MALE PINS THE LENGTH MUST BE (5.65)/.222 MIN & (7.00)/.276 MAX. TO ENSURE GOOD CONNECTION WITH CONTACT.
- 4) PRODUCT SPECIFICATION: PS-99020-0001
- 5) PCB THICKNESS 1.6MM

ADDE NOTE 4 & 5 EC NO: E2008-0119 DRWN:DBYRNES CHKD: APPR:EDMAHONY	2007/09/10	2007/09/10
	2007/09/10	2007/09/10
	2007/09/10	2007/09/10
	2007/09/10	2007/09/10

QUALITY SYMBOLS	DESCRIPTION
▽=0	
▽C=0	

GENERAL TOLERANCES (UNLESS SPECIFIED)	
mm	INCH
4 PLACES ± ---	± ---
3 PLACES ± ---	± ---
2 PLACES ± ---	± ---
1 PLACE ± ---	± ---
ANGULAR ± 2 °	
DRAFT WHERE APPLICABLE MUST REMAIN WITHIN DIMENSIONS	

DIMENSION STYLE	
MM/IN	
DRAWN BY	DATE
DB	1987/07/14
CHECKED BY	DATE
JDENNEHY	2005/07/07
APPROVED BY	DATE
JDENNEHY	2005/07/07
MATERIAL NO.	
SEE SHEET 2	

SCALE	DESIGN UNITS	THIRD ANGLE PROJECTION
5:1	METRIC	
C-GRID III, SINGLE ROW VERTICAL P.C. BOARD CONNECTOR ASSEMBLY.		
MOLEX INCORPORATED		
DOCUMENT NO.	SHEET NO.	
SDA-90147	1 OF 2	
THIS DRAWING CONTAINS INFORMATION THAT IS PROPRIETARY TO MOLEX INCORPORATED AND SHOULD NOT BE USED WITHOUT WRITTEN PERMISSION		

PART NO'S - STRAIGHT PINS	NO. OF CKTS	DIM. "A"	DIM. "B" (±.000)±.002	QTY. PER TUBE
90147-1X02	2	( 2.54 ) .100	( 5.08 ) .200	105
↑ 03	3	( 5.08 ) .200	( 7.62 ) .300	72
04	4	( 7.62 ) .300	( 10.16 ) .400	52
05	5	( 10.16 ) .400	( 12.70 ) .500	44
06	6	( 12.70 ) .500	( 15.24 ) .600	36
07	7	( 15.24 ) .600	( 17.78 ) .700	30
08	8	( 17.78 ) .700	( 20.32 ) .800	26
09	9	( 20.32 ) .800	( 22.86 ) .900	22
10	10	( 22.86 ) .900	( 25.40 ) 1.000	22
11	11	( 25.40 ) 1.000	( 27.94 ) 1.100	20
12	12	( 27.94 ) 1.100	( 30.48 ) 1.200	18
13	13	( 30.48 ) 1.200	( 33.02 ) 1.300	16
14	14	( 33.02 ) 1.300	( 35.56 ) 1.400	14
15	15	( 35.56 ) 1.400	( 38.10 ) 1.500	14
16	16	( 38.10 ) 1.500	( 40.64 ) 1.600	13
17	17	( 40.64 ) 1.600	( 43.18 ) 1.700	13
18	18	( 43.18 ) 1.700	( 45.72 ) 1.800	12
19	19	( 45.72 ) 1.800	( 48.26 ) 1.900	12
20	20	( 48.26 ) 1.900	( 50.80 ) 2.000	11
21	21	( 50.80 ) 2.000	( 53.34 ) 2.100	11
22	22	( 53.34 ) 2.100	( 55.88 ) 2.200	10
23	23	( 55.88 ) 2.200	( 58.42 ) 2.300	9
24	24	( 58.42 ) 2.300	( 60.96 ) 2.400	9
25	25	( 60.96 ) 2.400	( 63.50 ) 2.500	8
26	26	( 63.50 ) 2.500	( 66.04 ) 2.600	8
27	27	( 66.04 ) 2.600	( 68.58 ) 2.700	8
28	28	( 68.58 ) 2.700	( 71.12 ) 2.800	7
29	29	( 71.12 ) 2.800	( 73.66 ) 2.900	7
30	30	( 73.66 ) 2.900	( 76.20 ) 3.000	7
↓ 31	31	( 76.20 ) 3.000	( 78.74 ) 3.100	7
90147-1X 32	32	( 78.74 ) 3.100	( 81.28 ) 3.200	6

PLATING VERSION A  
 PRE-PLATED HOT DIP TIN  
 1.0 TO 2.5 um (.000040" TO .000100").

PLATING VERSION E  
 1.27 TO 1.78 um (.000050" TO .000070") NICKEL  
 OVERALL, 0.38 TO 0.64 um (.000015" TO .000025")  
 GOLD ON CONTACT AREA (OVER NICKEL),  
 3 TO 5 um (.000120" TO .000200") TIN  
 ON SOLDER TAILS (OVER NICKEL).

PLATING VERSION F.  
 1.27 TO 1.78 um (.000050" TO .000070") NICKEL  
 OVERALL, 0.76 TO 1.0 um (.000030" TO .000040")  
 GOLD ON CONTACT AREA (OVER NICKEL),  
 3 TO 5 um (.000120" TO .000200") TIN  
 ON SOLDER TAILS (OVER NICKEL).

PLATING VERSION N.  
 1.27 TO 1.78 um (.000050" TO .000070") NICKEL  
 OVERALL, 0.76 TO 2.6 um (.000030" TO .000100")  
 GOLD ON CONTACT AREA (OVER NICKEL),  
 4 um (.000120") MINIMUM TIN  
 ON SOLDER TAILS (OVER NICKEL).

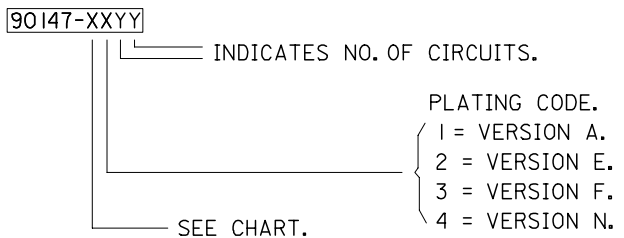

**STANDARD PRODUCTS**

REMOVE KINK OPT EC NO: E2007-0787 DRWN: WASZKI EWI CZ 2007/04/25 CHKD: DORJARTY 2007/04/25 APPR: DENNEHY 2007/04/27	QUALITY SYMBOLS ▽=0 ▽=0
AA	REV

GENERAL TOLERANCES (UNLESS SPECIFIED)	DIMENSION STYLE MM/IN	SCALE 5:1	DESIGN UNITS METRIC	THIRD ANGLE PROJECTION
4 PLACES ± --- ± --- 3 PLACES ± --- ± --- 2 PLACES ± --- ± --- 1 PLACE ± --- ± --- ANGULAR ± 2 °	DRAWN BY DB	DATE 1986/12/28	TITLE C-GRID III SINGLE ROW VERTICAL P.C. BOARD CONNECTOR	
DRAFT WHERE APPLICABLE MUST REMAIN WITHIN DIMENSIONS	APPROVED BY JDENNEHY	DATE 2005/07/07	MATERIAL NO. SEE CHART	DOCUMENT NO. SDA-90147
			SHEET NO. 2 OF 2	
THIS DRAWING CONTAINS INFORMATION THAT IS PROPRIETARY TO MOLEX INCORPORATED AND SHOULD NOT BE USED WITHOUT WRITTEN PERMISSION				