

41792

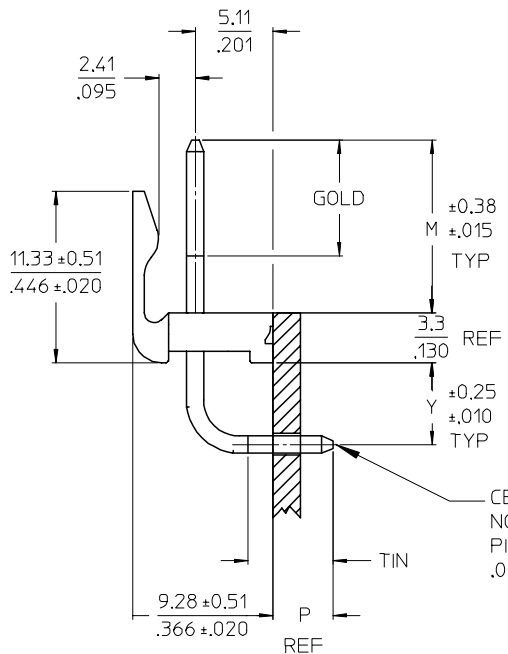

CENTERLINE OF PIN AT TIP NOT TO VARY FROM CENTERLINE OF PIN AT DATUM -D- BY MORE THAN .008 IN ANY DIRECTION.

CENTERLINE OF PIN AT TIP NOT TO VARY FROM CENTERLINE OF PIN AT DATUM -D- BY MORE THAN .008 IN ANY DIRECTION.

3.96±0.05  
.156±.002  
TYP. BETWEEN ANY 2 CONSECUTIVE CIRCUITS

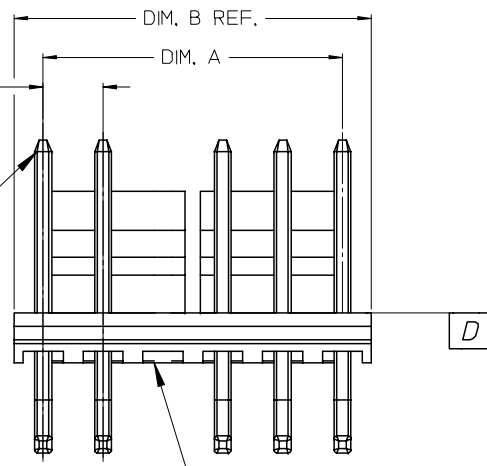

OPTIONAL VOIDED CIRCUIT SEE CHART FOR LOCATIONS

NOTES:

- MATERIAL: HEADER-GLASS FILLED POLYESTER, 94V-0, MOLDED NATURAL (WHITE).
- FINISH: (102) OVERALL TIN: .00508 MICROMETERS MIN OVER .00254 MICROMETERS MIN COPPER.  
\*(208) SELECT GOLD: .00038 MICROMETERS MIN, SELECT TIN: .00254 MICROMETERS MIN, OVERALL NICKEL UNDERPLATE: .00127 MICROMETERS MIN.  
\*(228) SELECT GOLD: .00076 MICROMETERS MIN, SELECT TIN: .00254 MICROMETERS MIN, OVERALL NICKEL UNDERPLATE: .00127 MICROMETERS MIN.  
FOR ADDITIONAL PLATING INFO, SEE SDES-88.  
\*THE PRIMARY SHIPPING CARTON WILL BE LABELED "COMPLIANT TO RoHS DIRECTIVE 2002/95/EC AND ELV ANNEX II OF DIRECTIVE 2000/53/EC". CARTONS WITHOUT THIS LABEL MAY CONTAIN PRODUCT WITH TIN-LEAD PLATING.
- PRODUCT SPECIFICATION AND PROCESS PARAMETERS: SEE PS-08-50.
- SOLDERABILITY: PER SMES-152.
- PIN PUSH-OUT FORCE: PRIOR TO SOLDERING, A 3 LB. MINIMUM FORCE (IN EITHER DIRECTION)
- PARTS ARE STACKABLE END TO END ON 3.96/.156 CENTERS.

CKT	DIM. A	DIM. B
2	3.96±0.05 .156±.002	7.77 .306
3	7.92±0.08 .312±.003	11.73 .462
4	11.89±0.08 .468±.003	15.70 .618
5	15.85±0.10 .624±.004	19.66 .774
6	19.81±0.10 .780±.004	23.62 .930
7	23.77±0.10 .936±.004	27.58 1.086
8	27.74±0.13 1.092±.005	31.55 1.242
9	31.70±0.13 1.248±.005	35.51 1.398
10	35.66±0.13 1.404±.005	39.47 1.554
11	39.62±0.15 1.560±.006	43.43 1.710
12	43.59±0.15 1.716±.006	47.40 1.866
13	47.55±0.15 1.872±.006	51.36 2.022
14	51.51±0.18 2.028±.007	55.32 2.178
15	55.47±0.18 2.184±.007	59.28 2.334
16	59.44±0.18 2.340±.007	63.25 2.490
17	63.40±0.20 2.496±.008	67.21 2.646
18	67.36±0.20 2.652±.008	71.17 2.802

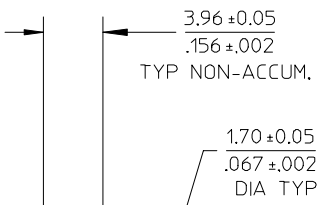

PCB LAYOUT: COMPONENT SIDE

LEAD FREE	DESCRIPTION
EC NO: UCP2004-1811	
DRWN:RCZUMA 2004/03/24	
CHKD: 2004/03/25	
APPR: YMARGULI 2004/03/26	

GENERAL TOLERANCES (UNLESS SPECIFIED)	
mm	INCH
4 PLACES ± ---	± ---
3 PLACES ± ---	± .010
2 PLACES ± 0.25	± .015
1 PLACE ± 0.38	± ---
ANGULAR ± 1/2°	
DRAFT WHERE APPLICABLE	
MUST REMAIN WITHIN DIMENSIONS	

SCALE 2:1	DESIGN UNITS INCH
DIMENSION STYLE MM/IN	
DRAWN BY JSCHAFFER	DATE 11-07-03
CHECKED BY KSAMIEC	DATE 11-10-03
APPROVED BY MARGULIS	DATE 11-17-03

THIRD ANGLE PROJECTION	REVISE ON CAD ONLY	
TITLE KK 156 HEADER ASSEMBLY FRICTION LOCK RIGHT ANGLE W/O PEGS		
MOLEX INCORPORATED		
MATERIAL NO. SEE CHART	DOCUMENT NO. SDA-41792	SHEET NO. 1 OF *
THIS DRAWING CONTAINS INFORMATION THAT IS PROPRIETARY TO MOLEX INCORPORATED AND SHOULD NOT BE USED WITHOUT WRITTEN PERMISSION		

OPTIONS	Group	A-41792-0002/0018	Group	A-41792-0511/0527	Group	A-41792-0528/0544	Group	
	Header No:	41790-0002/0018	Header No:	41790-0002/0018	Header No:	41790-0002/0018	Header No:	
	Pin No:	2161-37(102)	Pin No:	43294-0569	Pin No:	43294-0570	Pin No:	
	Plating:	102 – TIN	Plating:	208 – 15 GOLD	Plating:	228 – 30 GOLD	Plating:	
	Pin Length L	27.94 / 1.100	Pin Length L	27.94 / 1.100	Pin Length L	27.94 / 1.100	Pin Length L	
	Mating M	11.43 / .450	Mating M	11.43 / .450	Mating M	11.43 / .450	Mating M	
	Gold Loc G	N/A	Gold Loc G	6.86/ .270	Gold Loc G	6.86/ .270	Gold Loc G	
	Height Y	5.41 / .213	Height Y	5.41 / .213	Height Y	5.41 / .213	Height Y	
	PC Tail P	3.96/ .156	PC Tail P	3.96/ .156	PC Tail P	3.96/ .156	PC Tail P	
	Tin Loc T	OVERALL	Tin Loc T	4.83/ .190	Tin Loc T	4.83/ .190	Tin Loc T	
	Voided Ckts	NONE	Voided Ckts	NONE	Voided Ckts	NONE	Voided Ckts	
	Pack Per	PK-41792-002	Pack Per	PK-41792-002	Pack Per	PK-41792-002	Pack Per	
Ckts	Material No	Engineer Number	Material No	Engineer Number	Material No	Engineer Number	Material No	Engineer Number
2	26-60-5020	A-41792-0002	41792-0511	A-41792-0511	41792-0528	A-41792-0528		
3	26-60-5030	A-41792-0003	41792-0512	A-41792-0512	41792-0529	A-41792-0529		
4	26-60-5040	A-41792-0004	41792-0513	A-41792-0513	41792-0530	A-41792-0530		
5	26-60-5050	A-41792-0005	41792-0514	A-41792-0514	41792-0531	A-41792-0531		
6	26-60-5060	A-41792-0006	41792-0515	A-41792-0515	41792-0532	A-41792-0532		
7	26-60-5070	A-41792-0007	41792-0516	A-41792-0516	41792-0533	A-41792-0533		
8	26-60-5080	A-41792-0008	41792-0517	A-41792-0517	41792-0534	A-41792-0534		
9	26-60-5090	A-41792-0009	41792-0518	A-41792-0518	41792-0535	A-41792-0535		
10	26-60-5100	A-41792-0010	41792-0519	A-41792-0519	41792-0536	A-41792-0536		
11	26-60-5110	A-41792-0011	41792-0520	A-41792-0520	41792-0537	A-41792-0537		
12	26-60-5120	A-41792-0012	41792-0521	A-41792-0521	41792-0538	A-41792-0538		
13	26-60-5130	A-41792-0013	41792-0522	A-41792-0522	41792-0539	A-41792-0539		
14	26-60-5140	A-41792-0014	41792-0523	A-41792-0523	41792-0540	A-41792-0540		
15	26-60-5150	A-41792-0015	41792-0524	A-41792-0524	41792-0541	A-41792-0541		
16	26-60-5160	A-41792-0016	41792-0525	A-41792-0525	41792-0542	A-41792-0542		
17	26-60-5170	A-41792-0017	41792-0526	A-41792-0526	41792-0543	A-41792-0543		
18	26-60-5180	A-41792-0018	41792-0527	A-41792-0527	41792-0544	A-41792-0544		

REV:		TITLE:	<b>KK 156 HEADER ASSEMBLY FRICTION LOCK RIGHT ANGLE BREAKAWAY</b>		SHEET No.
<b>F</b>	04-01-05 REDRAWN, WORDPRO				<b>- 2 -</b>
DOCUMENT NUMBER: <b>SDA- 41792</b>		CREATED / REVISED BY: <b>CSTEWART</b>		CHECKED BY: <b>SAMIEC</b>	APPROVED BY: <b>MARGULIS</b>

OPTIONS	Group	A-41792-0019/0035	Group	A-41792-0036/0050	Group		Group	
	Header No:	41790-0002/0018	Header No:	41790-0003/0018	Header No:		Header No:	
	Pin No:	2161-37(501)	Pin No:	2161-37(102)	Pin No:		Pin No:	
	Plating:	501 – GOLD	Plating:	102 – TIN	Plating:		Plating:	
	Pin Length L	27.94 / 1.100	Pin Length L	27.94 / 1.100	Pin Length L		Pin Length L	
	Mating M	11.43 / .450	Mating M	11.43 / .450	Mating M		Mating M	
	Gold Loc G	OVERALL	Gold Loc G	N/A	Gold Loc G		Gold Loc G	
	Height Y	5.41 / .213	Height Y	5.41 / .213	Height Y		Height Y	
	PC Tail P	3.96/ .156	PC Tail P	3.96/ .156	PC Tail P		PC Tail P	
	Tin Loc T	N/A	Tin Loc T	OVERALL	Tin Loc T		Tin Loc T	
	Voided Ckts	NONE	Voided Ckts	4	Voided Ckts		Voided Ckts	
	Pack Per	PK-41792-002	Pack Per	PK-41792-002	Pack Per		Pack Per	
C k t s	Material No	Engineer Number	Material No	Engineer Number	Material No	Engineer Number	Material No	Engineer Number
	2	26-61-5020	A-41792-0019					
	3	26-61-5030	A-41792-0020					
	4	26-61-5040	A-41792-0021	26-61-5043	A-41792-0036			
	5	26-61-5050	A-41792-0022	26-61-5053	A-41792-0037			
	6	26-61-5060	A-41792-0023	26-61-5063	A-41792-0038			
	7	26-61-5070	A-41792-0024	26-61-5073	A-41792-0039			
	8	26-61-5080	A-41792-0025	26-61-5083	A-41792-0040			
	9	26-61-5090	A-41792-0026	26-61-5093	A-41792-0041			
	10	26-61-5100	A-41792-0027	26-61-5103	A-41792-0042			
	11	26-61-5110	A-41792-0028	26-61-5113	A-41792-0043			
	12	26-61-5120	A-41792-0029	26-61-5123	A-41792-0044			
	13	26-61-5130	A-41792-0030	26-61-5133	A-41792-0045			
	14	26-61-5140	A-41792-0031	26-61-5143	A-41792-0046			
	15	26-61-5150	A-41792-0032	26-61-5153	A-41792-0047			
	16	26-61-5160	A-41792-0033	26-61-5163	A-41792-0048			
	17	26-61-5170	A-41792-0034	26-61-5173	A-41792-0049			

18	REV. 04-01-05	A-41792-0035	TITLE	A-41792-0050	<b>KK 156 HEADER ASSEMBLY          FRICTION LOCK RIGHT ANGLE          BREAKAWAY</b>			SHEET No. <b>- 3 -</b>
----	---------------	--------------	-------	--------------	---	--	--	---------------------------

DOCUMENT NUMBER: <b>SDA- 41792</b>	CREATED / REVISED BY: <b>CSTEWART</b>	CHECKED BY: <b>SAMIEC</b>	APPROVED BY: <b>MARGULIS</b>
---------------------------------------	--	------------------------------	---------------------------------

OPTIONS	Group	A-41792-0198/0213	Group	A-41792-0214/0227	Group	A-41792-0242/0257	Group	A-41792-0341/0352
	Header No:	41790-0002/0018	Header No:	41790-0005/0018	Header No:	41790-0003/0018	Header No:	41790-0007/0018
	Pin No:	2161-37(102)	Pin No:	2161-37(102)	Pin No:	2161-37(102)	Pin No:	2161-37(102)
	Plating:	102 – TIN	Plating:	102 – TIN	Plating:	102 – TIN	Plating:	102 – TIN
	Pin Length L	27.94/ 1.100	Pin Length L	27.94/ 1.100	Pin Length L	27.94/ 1.100	Pin Length L	27.94/ 1.100
	Mating M	11.43 / .450	Mating M	11.43 / .450	Mating M	11.43 / .450	Mating M	11.43 / .450
	Gold Loc G	N/A	Gold Loc G	N/A	Gold Loc G	N/A	Gold Loc G	N/A
	Height Y	5.41 / .213	Height Y	5.41 / .213	Height Y	5.41 / .213	Height Y	5.41 / .213
	PC Tail P	3.96 / .156	PC Tail P	3.96 / .156	PC Tail P	3.96 / .156	PC Tail P	3.96 / .156
	Tin Loc T	OVERALL	Tin Loc T	OVERALL	Tin Loc T	OVERALL	Tin Loc T	OVERALL
	Voided Ckts	2	Voided Ckts	5	Voided Ckts	3	Voided Ckts	7
	Pack Per	PK-41792-002	Pack Per	PK-41792-002	Pack Per	PK-41792-002	Pack Per	PK-41792-002
Ckts	Material No	Engineer Number	Material No	Engineer Number	Material No	Engineer Number	Material No	Engineer Number
2								
3	26-62-5031	A-41792-0198			26-62-5035	A-41792-0242		
4	26-62-5041	A-41792-0199			26-62-5045	A-41792-0243		
5	26-62-5051	A-41792-0200	41792-0214	A-41792-0214	26-62-5055	A-41792-0244		
6	26-62-5061	A-41792-0201	26-62-5060	A-41792-0215	26-62-5065	A-41792-0245		
7	26-62-5071	A-41792-0202	41792-0216	A-41792-0216	26-62-5075	A-41792-0246	41792-0341	A-41792-0341
8	26-62-5081	A-41792-0203	41792-0217	A-41792-0217	26-62-5085	A-41792-0247	41792-0342	A-41792-0342
9	26-62-5091	A-41792-0204	41792-0218	A-41792-0218	26-62-5095	A-41792-0248	41792-0343	A-41792-0343
10	26-62-5101	A-41792-0205	26-62-5100	A-41792-0219	26-62-5105	A-41792-0249	26-62-5104	A-41792-0344
11	26-62-5111	A-41792-0206	41792-0220	A-41792-0220	26-62-5115	A-41792-0250	26-62-5114	A-41792-0345
12	26-62-5121	A-41792-0207	41792-0221	A-41792-0221	26-62-5125	A-41792-0251	41792-0346	A-41792-0346
13	26-62-5131	A-41792-0208	41792-0222	A-41792-0222	26-62-5135	A-41792-0252	41792-0347	A-41792-0347
14	26-62-5141	A-41792-0209	41792-0223	A-41792-0223	26-62-5145	A-41792-0253	41792-0348	A-41792-0348
15	26-62-5151	A-41792-0210	41792-0224	A-41792-0224	26-62-5155	A-41792-0254	41792-0349	A-41792-0349
16	26-62-5161	A-41792-0211	41792-0225	A-41792-0225	26-62-5165	A-41792-0255	41792-0350	A-41792-0350
17	26-62-5171	A-41792-0212	41792-0226	A-41792-0226	26-62-5175	A-41792-0256	41792-0351	A-41792-0351
18	26-62-5181	A-41792-0213	41792-0227	A-41792-0227	26-62-5185	A-41792-0257	41792-0352	A-41792-0352

REV:	04-01-05 REDRAWN, WORDPRO	TITLE:	<b>KK 156 HEADER ASSEMBLY          FRICTION LOCK RIGHT ANGLE          BREAKAWAY</b>	SHEET No.
<b>F</b>				
DOCUMENT NUMBER:		CREATED / REVISED BY:	CHECKED BY:	APPROVED BY:
<b>SDA- 41792</b>		<b>CSTEWART</b>	<b>SAMIEC</b>	<b>MARGULIS</b>

OPTIONS	Group	A-41792-0460/0471	Group	A-41792-0472/0483	Group	A-41792-0484/0493	Group	
	Header No:	41790-0007/0018	Header No:	41790-0007/0018	Header No:	41790-0009/0018	Header No:	
	Pin No:	2161-37(102)	Pin No:	2161-37(102)	Pin No:	2161-37(102)	Pin No:	
	Plating:	102 – TIN	Plating:	102 – TIN	Plating:	102 – TIN	Plating:	
	Pin Length L	27.94 / 1.100	Pin Length L	27.94 / 1.100	Pin Length L	27.94 / 1.100	Pin Length L	
	Mating M	11.43 / .450	Mating M	11.43 / .450	Mating M	11.43 / .450	Mating M	
	Gold Loc G	N/A	Gold Loc G	N/A	Gold Loc G	N/A	Gold Loc G	
	Height Y	5.41 / .213	Height Y	5.41 / .213	Height Y	5.41 / .213	Height Y	
	PC Tail P	3.96 / .156	PC Tail P	3.96 / .156	PC Tail P	3.96 / .156	PC Tail P	
	Tin Loc T	OVERALL	Tin Loc T	OVERALL	Tin Loc T	OVERALL	Tin Loc T	
	Voided Ckts	2, 7	Voided Ckts	4, 7	Voided Ckts	2, 5, 9	Voided Ckts	
	Pack Per	PK-41792-002	Pack Per	PK-41792-002	Pack Per	PK-41792-002	Pack Per	
Ckts	Material No	Engineer Number	Material No	Engineer Number	Material No	Engineer Number	Material No	Engineer Number
2								
3								
4								
5								
6								
7	41792-0460	A-41792-0460		A-41792-0472				
8	41792-0461	A-41792-0461	26-60-5087	A-41792-0473				
9	26-60-5096	A-41792-0462		A-41792-0474		A-41792-0484		
10	41792-0463	A-41792-0463		A-41792-0475		A-41792-0485		
11	41792-0464	A-41792-0464		A-41792-0476		A-41792-0486		
12	41792-0465	A-41792-0465		A-41792-0477	26-60-5128	A-41792-0487		
13	41792-0466	A-41792-0466		A-41792-0478		A-41792-0488		
14	41792-0467	A-41792-0467		A-41792-0479		A-41792-0489		
15	41792-0468	A-41792-0468		A-41792-0480		A-41792-0490		
16	41792-0469	A-41792-0469		A-41792-0481		A-41792-0491		
17	41792-0470	A-41792-0470		A-41792-0482		A-41792-0492		
18	41792-0471	A-41792-0471		A-41792-0483		A-41792-0493		

REV:		TITLE:	<b>KK 156 HEADER ASSEMBLY FRICTION LOCK RIGHT ANGLE BREAKAWAY</b>		SHEET No.		
<b>F</b>	04-01-05 REDRAWN, WORDPRO				<b>- 5 -</b>		
DOCUMENT NUMBER:	<b>SDA- 41792</b>	CREATED / REVISED BY:	<b>CSTEWART</b>	CHECKED BY:	<b>SAMIEC</b>	APPROVED BY:	<b>MARGULIS</b>