

PC board drilling dimensions(after plating)

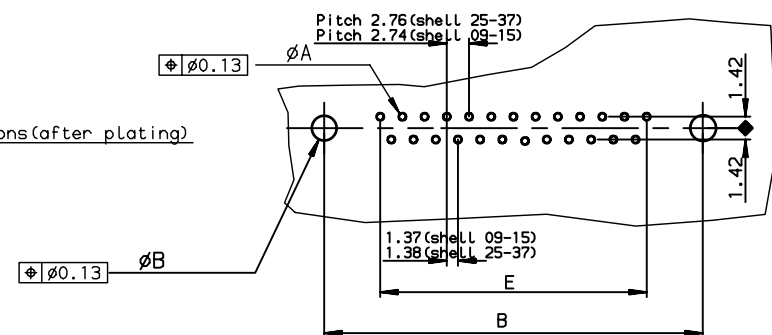

TIN LEAD PART NUMBER

SHELL	A±0.38	B±0.12	C±0.10	D±0.25	E±0.07	PART NUMBER	PART NUMBER
09	30.81	24.99	16.96	16.79	10.96	D09P91C4PX00	D09P91C6PX00
15	39.14	33.32	25.18	25.12	19.18	D15P91C4PX00	D15P91C6PX00
25	53.03	47.04	39.12	38.84	33.12	D25P91C4PX00	D25P91C6PX00
37	69.32	63.50	55.68	55.30	49.68	D37P91C4PX00	D37P91C6PX00
						gold flash	0.76µ gold

LEAD FREE PART NUMBER

SHELL	A±0.38	B±0.12	C±0.10	D±0.25	E±0.07	PART NUMBER	PART NUMBER
09	30.81	24.99	16.96	16.79	10.96	D09P91C4PX00LF	D09P91C6PX00LF
15	39.14	33.32	25.18	25.12	19.18	D15P91C4PX00LF	D15P91C6PX00LF
25	53.03	47.04	39.12	38.84	33.12	D25P91C4PX00LF	D25P91C6PX00LF
37	69.32	63.50	55.68	55.30	49.68	D37P91C4PX00LF	D37P91C6PX00LF
						gold flash	0.76µ gold

rev	ecn no	dr	date
F	-	-	1996/07/07
G	LS05-004	MPE	1996/07/07
H	LS06-0042	MPE	2006/03/20
J	LS06-0097	LGO	2006/07/29
K	LS06-0140	LGO	2006/29/03
-	-	-	-
-	-	-	-

GENERAL CHARACTERISTICS AND ROHS INFORMATIONS:

SEE DRAWING C01-8646-0001

European Views

www.fciconnect.com		surface ISO 1302	tolerance std ISO 406 ISO 1101	projection A3	mm
		TOLERANCES UNLESS OTHERWISE SPECIFIED		size A3	Scale 2
Dr	M PESSON	1992/09/14	ANGULAR	0.X	±0.1
Eng	M PESSON	1992/09/14	LINEAR	0.XX	±0.1
Chr	P LEGARE	1992/09/14	0.XX' ±2'	0.XXX	±0.1
Appr	P LEGARE	1992/09/14	Product family	D-SUB	Spec ref -
FCJ		MALE CONNECTOR DELTA D EU		dwg no	Rev.
		STRAIGHT PRESS FIT		C01-8646-0111	K
catalog no		CUSTOMER		sheet 1 of 1	