

PC board drilling dimensions (after plating)
(thickness < 3.20 ± 0.30mm)

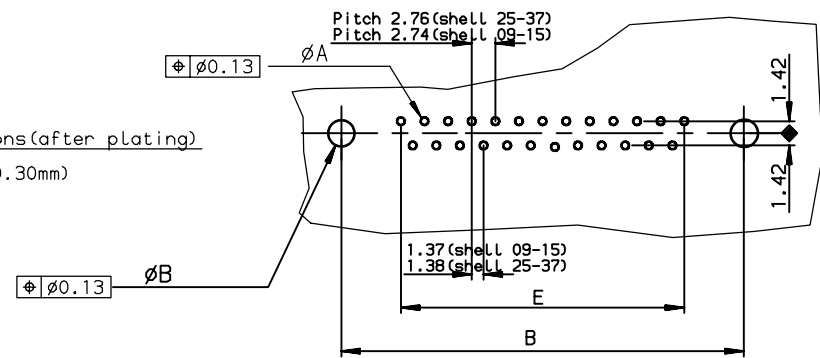

TIN LEAD PART NUMBER

SHELL	A±0.38	B±0.12	C±0.10	D±0.25	E±0.07	PART NUMBER	PART NUMBER
09	30.81	24.99	16.96	16.21	10.96	D09S90C4PV00	D09S90C6PV00
15	39.14	33.32	25.18	24.54	19.18	D15S90C4PV00	D15S90C6PV00
25	53.03	47.04	39.12	38.25	33.12	D25S90C4PV00	D25S90C6PV00
37	69.32	63.50	55.68	54.71	49.68	D37S90C4PV00	D37S90C6PV00
						gold flash	0.76µ gold

LEAD FREE PART NUMBER

SHELL	A±0.38	B±0.12	C±0.10	D±0.25	E±0.07	PART NUMBER	PART NUMBER
09	30.81	24.99	16.96	16.21	10.96	D09S90C4PV00LF	D09S90C6PV00LF
15	39.14	33.32	25.18	24.54	19.18	D15S90C4PV00LF	D15S90C6PV00LF
25	53.03	47.04	39.12	38.25	33.12	D25S90C4PV00LF	D25S90C6PV00LF
37	69.32	63.50	55.68	54.71	49.68	D37S90C4PV00LF	D37S90C6PV00LF
						gold flash	0.76µ gold

GENERAL CHARACTERISTICS AND ROHS INFORMATIONS:
SEE DRAWING C01-8646-0001

European Views

www.fciconnect.com		surface ISO 1302	tolerance std ISO 406 ISO 1101	projection mm
		TOLERANCES UNLESS OTHERWISE SPECIFIED		
Dr	PESSON	1991/07/19	0.X	±0.1
Eng	PESSON	1991/07/19	0.XX	±0.1
Chr	LEGARE	1991/07/19	0.XX	±0.1
Appr	LEGARE	1991/07/19	0.XXX	±0.1
Product family		D-SUB		size A3
Product family		D-SUB		Scale 2
Product family		D-SUB		ECN LS06-0140
Product family		D-SUB		Spec ref -
FCI		FEMALE CONNECTOR DELTA D LOW PROFIL		Rev. G
FCI		straight press-fit		dwg no C01-8646-0034
catalog no		-		CUSTOMER sheet 1 of 1

rev	ecn no	dr	date
D	-	-	1997/07/23
E	LS05-004	MPE	2005/02/07
F	LS06-0095	LGO	2006/06/17
G	LS06-0140	LGO	2006/09/22
-	-	-	-
-	-	-	-
-	-	-	-

Copyright FCI. FCI