

PC BOARD VERSIONS		
PRODUCTNR:	PCB THICKNESS	DIM "A"
70227-X01/X01LF	1.6	2.73
70227-X11/X11LF	2.4	3.53

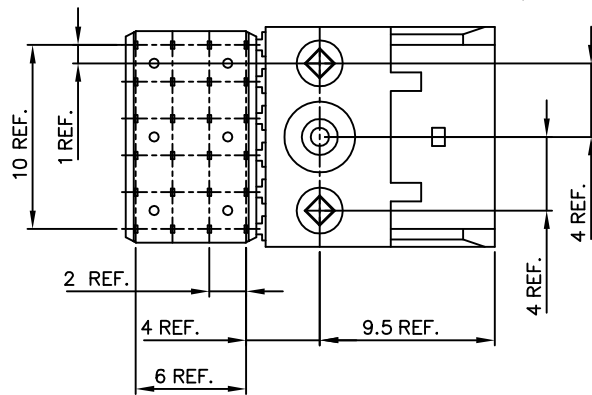

PRODUCT AFTER HOT RIVETTING.

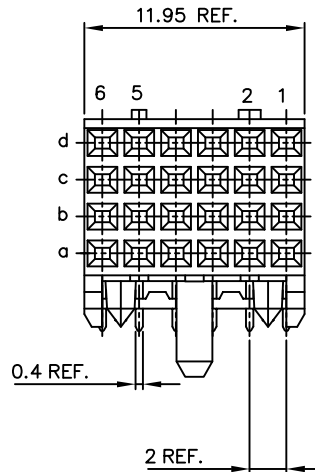
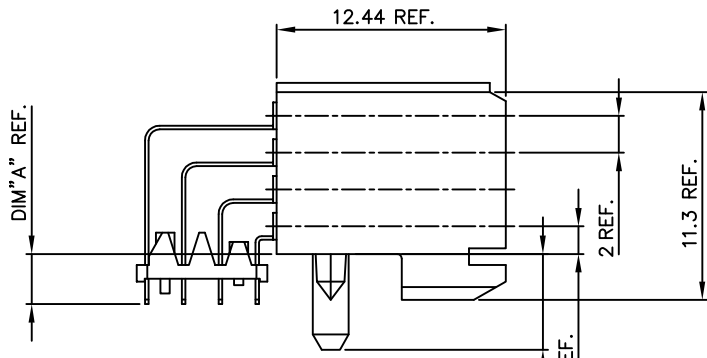
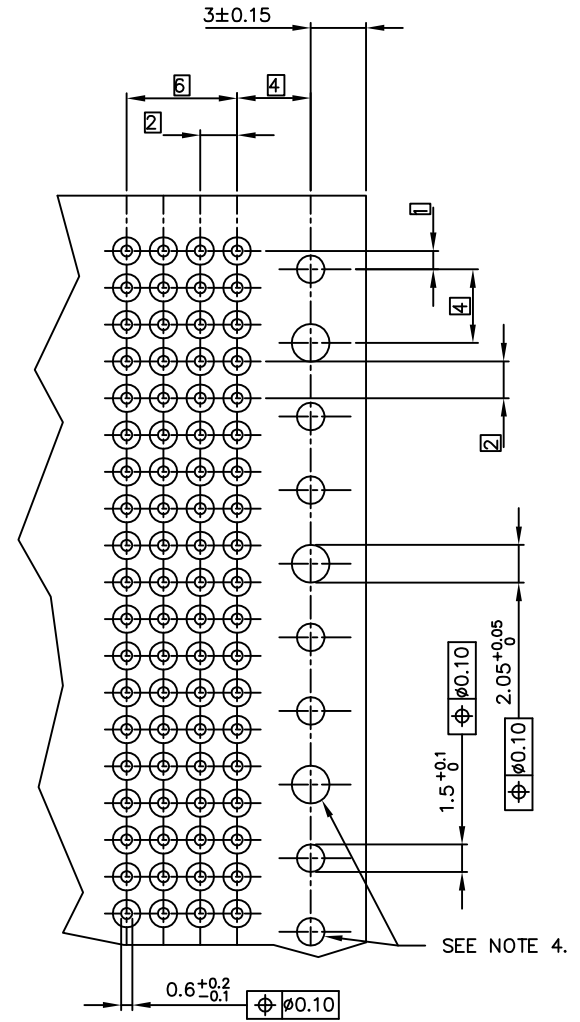
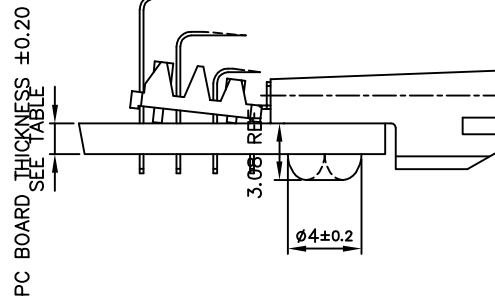

RECOMMENDED HOLE PATTERN, COMPONENT SIDE.

NOTES:

- BODY MAT'L: LIQUID CRYSTAL POLYMER 30% GLASS
FLAME RETARDANT ACC. UL 94-V0
- TERMINAL MATERIAL: PHOSPHOR BRONZE.
- PLATING SOLDER TAILS 2-8 µm SnPb 90-97 OR 2-8 µm PURE Sn
- INDICATED HOLES ARE UNPLATED.
- PRODUCT MARKING: PARTNUMBER & BATCH ID.
- THIS PRODUCT MEETS EUROPEAN UNION DIRECTIVES AND OTHER COUNTRY REGULATIONS AS DESCRIBED IN GS-22-008.
- THE HOUSING WILL WITHSTAND EXPOSURE TO 260 DEGREE PEAK TEMPERATURE FOR 10 SECONDS IN A WAVE SOLDER APPLICATION.

PRODUCT NR:	PLATING CONTACT AREA:	UNDERPLATING
70227-1YZ/1YZLF	0.8 µm GOLD	1.3 µm Ni MIN.
70227-2YZ/2YZLF	2 µm GOLD	1.3 µm Ni MIN.
70227-3YZ/3YZLF	1.3 µm GOLD	1.3 µm Ni MIN.
70227-9YZ/9YZLF	0.8 µm GXT	1.3 µm Ni MIN.

mat'l. code		tolerances unless otherwise specified		CUSTOMER COPY		ELECTRONICS	
ltr	ecn no dr date	dr	date	projection	title	product family	code
K	0004-0104	Clu	041221	linear	RA FEMALE SIGNAL STB 12 mm VERSION	ETRAL(tm)	213
E	H30759	EFE	940118	angles			
F	H40118	EFE	940211	dr	R.Trippe	900918	
G	V70769	DOB	970602	eng	H. Bouwknecht	940308	
H	V00578	LLA	000316	chr	A van Zanten	900918	
J	V00847	LLA	000530	app	H v Woensel	900918	
sheet	revisor	K	K	scale	5:1	A2	70227
Indx	sheet	1	2	size	dwg no		1 of 2

PDM: Rev.K

STATUS: Released

Printed: Mar 16, 2006

PC BOARD VERSIONS		
PRODUCTNR:	PCB THICKNESS	DIM "A"
70227-X02/X02LF	1.6	2.73
70227-X12/X12LF	2.4	3.53

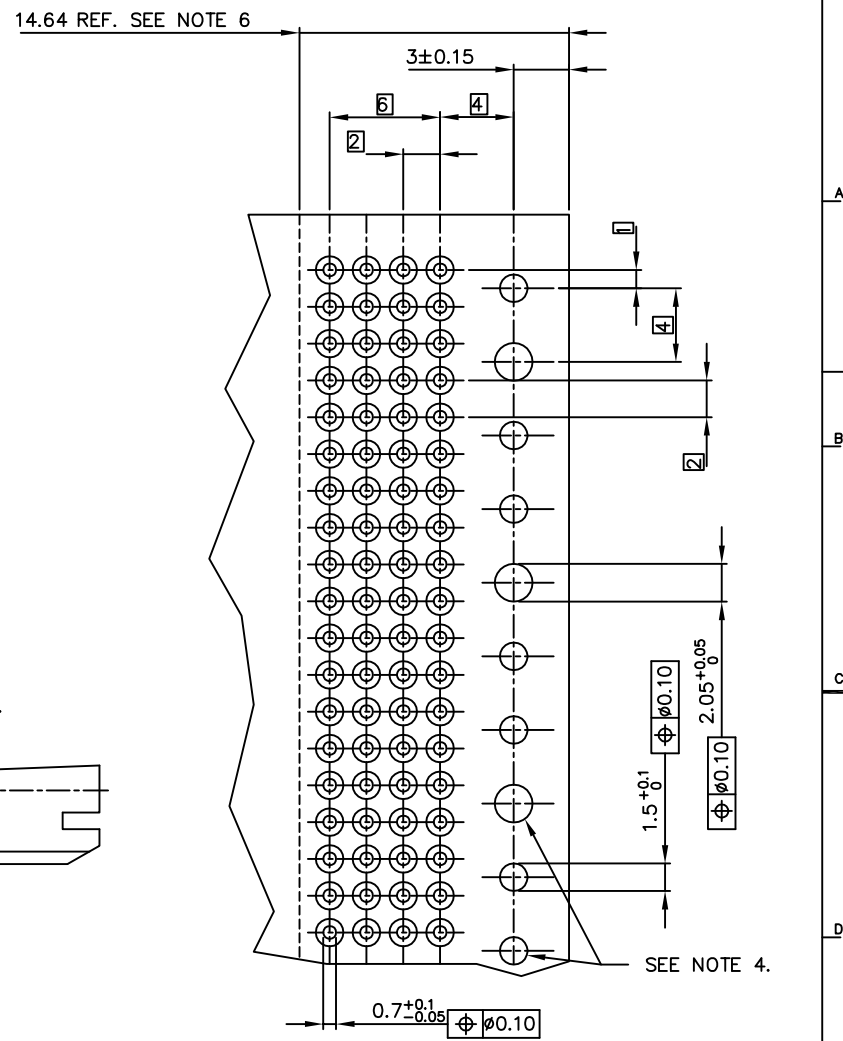
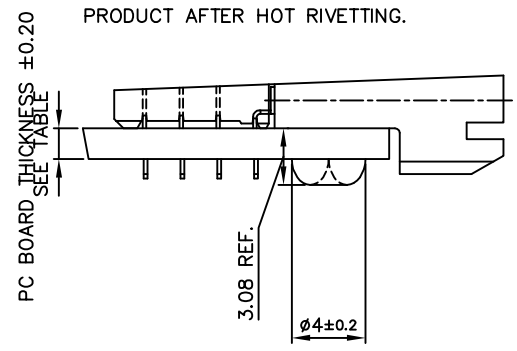
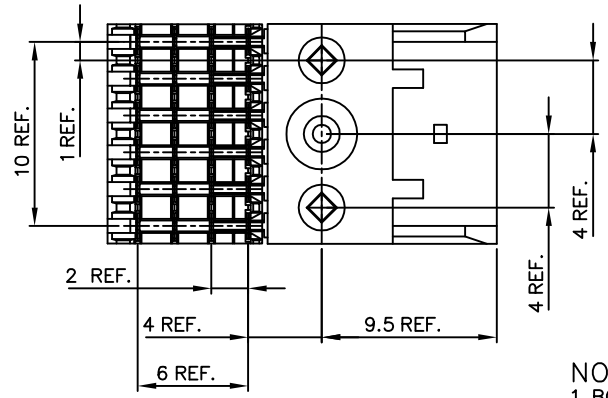
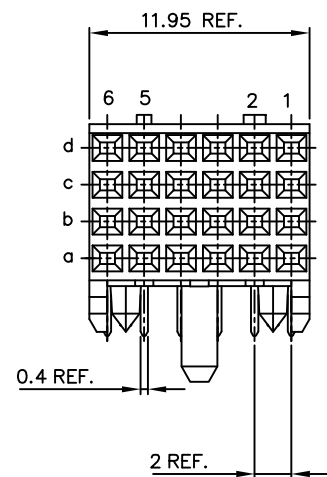
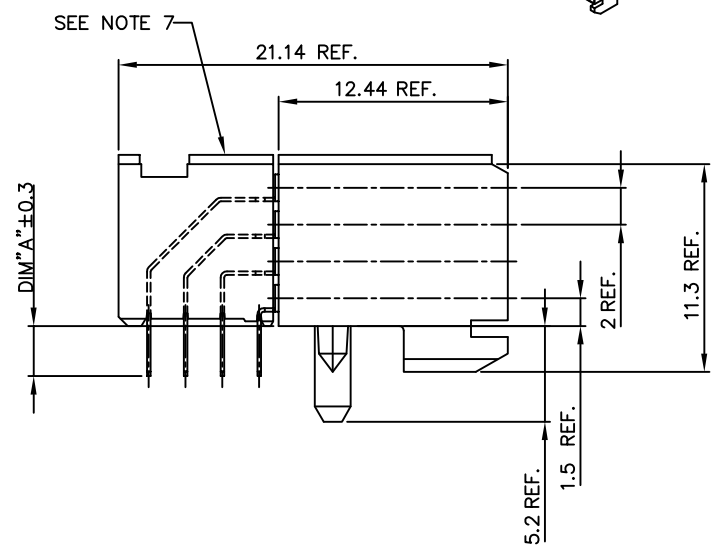
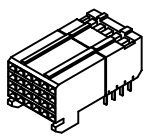

- NOTES:**
- BODY MAT'L: LIQUID CRYSTAL POLYMER 30% GLASS FLAME RETARDANT ACC. UL 94-V0
 - TERMINAL MATERIAL: PHOSPHOR BRONZE.
 - PLATING SOLDER TAILS 2-8 µm SnPb 90-97 OR 2-8 µm PURE Sn
 - INDICATED HOLES ARE UNPLATED.
 - PRODUCT MARKING: PARTNUMBER & BATCH ID.
 - SET BACK FOR PRESS BLOCK.
 - TOP SURFACE OF PRESS BLOCK MAY EXTEND UP TO 0.4MM HIGHER THAN HOUSING. THIS MAY AFFECT THE TAIL LENGTH BEFORE APPLICATION TO A BOARD
 - THIS PRODUCT MEETS EUROPEAN UNION DIRECTIVES AND OTHER COUNTRY REGULATIONS AS DESCRIBED IN GS-22-008.
 - THE HOUSING WILL WITHSTAND EXPOSURE TO 260DEGREE PEAK TEMPERATURE FOR 10 SECONDS IN A WAVE SOLDER APPLICATION.

RECOMMENDED HOLE PATTERN, COMPONENT SIDE.

PRODUCT NR:	PLATING CONTACT AREA:	UNDERPLATING
70227-1YZ/1YZLF	0.8 µm GOLD	1.3 µm Ni MIN.
70227-2YZ/2YZLF	2 µm GOLD	1.3 µm Ni MIN.
70227-3YZ/3YZLF	1.3 µm GOLD	1.3 µm Ni MIN.
70227-9YZ/9YZLF	0.8 µm GXT	1.3 µm Ni MIN.

mat'l. code		tolerances unless otherwise specified		CUSTOMER COPY		ELECTRONICS	
ltr	ecn no dr date	linear		projection	title	product family	code
k		angles		mm	RA FEMALE SIGNAL STB 12 mm VERSION	NETRAL(tm)	213
		dr	D. de Bill 970529	scale	5:1	70227	sheet 2 of-
		engr	P. Schalk 970529				
		chr	P. Schalk 970529				
		appd	H. Cozijmans 970529				
sheet	revision						
index	sheet						

PDM: Rev.K

STATUS: Released

Printed: Mar 16, 2006

All rights reserved. Reproduction or use in any form without written permission is prohibited. FCI logo and text.