

**Broadband Access Transformer**

- Designed to meet UL 60950-1 and IEC 60950-1 requirements for supplementary insulation
- RoHS Compliant
- Operating Temperature -40°C to +85°C

Electrical Specifications @25°C	
OCL:	PIN 16-9= 400uH ±10% @ 10KHz/0.1V/Series (PIN 11-14 Short)
Leakage Inductance:	PIN 16-9= 3.5uH Max. @ 100KHz/0.1V (PIN 11-14, 1,2-3,4 Short)
	PIN 16-9= 2.5uH Max. @ 100KHz/0.1V (PIN 11-14, 6-7, 5-8 Short)
D.C.R	PIN 1-4 = 0.3 ohm Max. (PIN 1,2-3,4 Short)
	PIN 5-8 = 4.4 ohm Max. (PIN 6-7 Short)
	PIN 16-9 = 3.0 ohm Max. (PIN 11-14 Short)
Turn Ratio:	PIN16-9 : PIN 1-4 = 4.25±3% :1 (PIN 11-14, PIN1,2-3,4 Short)
	PIN16-9 : PIN 5-8 = 1±3% :1 (PIN 11-14, PIN6-7 Short)
T.H.D	PIN16-9 - PIN5-8 = -82dB Max. @ 30KHz/3.162V (PIN11-14, PIN6-7 Short)
Hi-POT :	PRI. – SEC. =1875VAC/60Hz/2Seconds/1mA

**Dimensions**

(Units: mm, Unless otherwise specified, all tolerances are ±0.25)

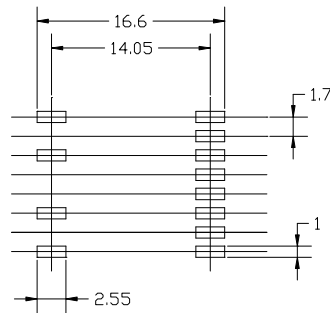
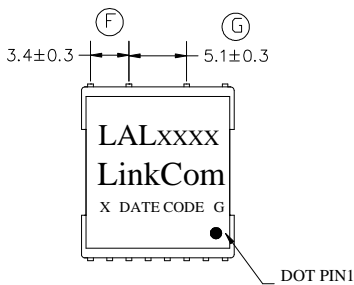

SUGGESTED PADS LAYOUT

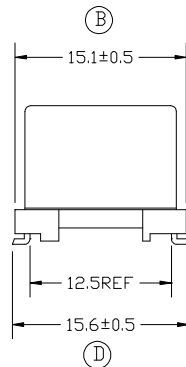
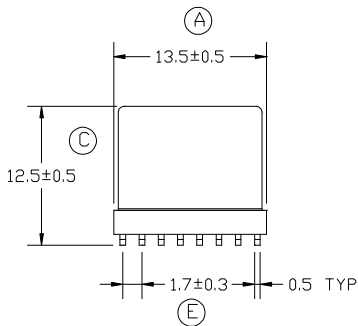

**Schematic**

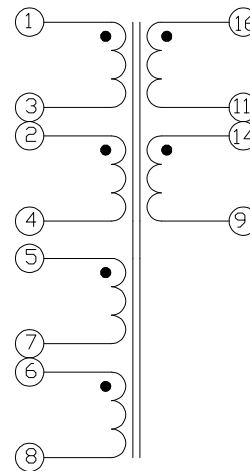

**Mark**

- 1.LAL \*\*\*\*----LAL2108
2. X----PRODUCT LINE or BLANK
3. DATE CODE----YYWW
4. G----RoHS