

Slide



C&K 1000 Series Miniature Slide Switches

SWITCH FUNCTION



NO. POLES	MODEL NO.	SWITCH FUNCTION			CONNECTED TERMINALS			SCHEMATIC
		POS. 1	POS. 2	POS. 3	POS. 1	POS. 2	POS. 3	
SP	1101 (STD.)	ON	NONE	ON	1-2	N/A	2-3	
	1103	ON	OFF	ON		OPEN		
	1108	MOM.	NONE	ON		N/A		
SPDT								

SPDT

Part number shown: 1101M2S3CQE2

Terminal Nos.
For Reference Only

DP	1201	ON	NONE	ON	2-1,5-4	OPEN	2-3,5-6	
	1203	ON	OFF	ON				
DPDT								

DPDT

Part number shown: 1201M2S3CQE2

Terminal Nos.
For Reference Only

MOM. = Momentary

All models with all options when ordered with G, L, M or Q contact material.

MOUNTING STYLE



M2 (STD.) PC MOUNTING WITHOUT TABS

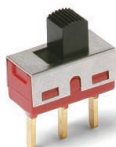

NOTE: Available with A, AV2, C, V3, V4, W terminations only.

M1 PANEL MOUNTING WITH TABS

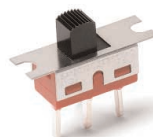

NOTE: Available with C, W, Z, Z3 terminations only. No mounting hardware supplied.

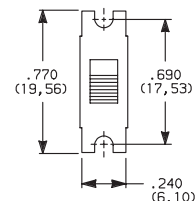

PANEL MOUNTING

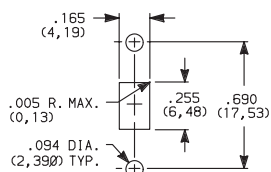

All actuators except T3.
Single pole

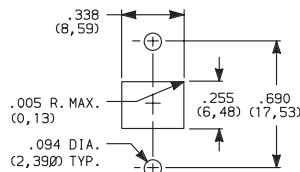

For T3 actuator only.
Double pole

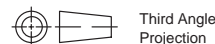

Dimensions are shown: IN (mm)
Dimensions subject to change

C&K 1000 Series Miniature Slide Switches

ACTUATOR

ACTUATOR COLOR

ACTUATOR

S3 (STD.) .200" HIGH

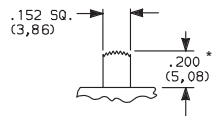

S2 .140" HIGH

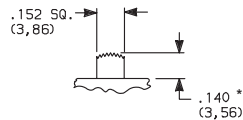

110X models only.

S1 .040" HIGH

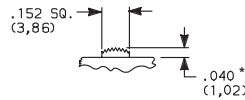

120X models only.

S4 .285" HIGH

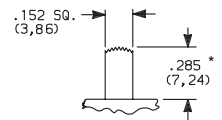

S5 .370" HIGH

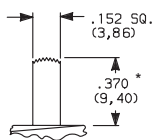

S6 .485" HIGH

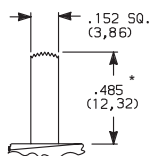

T3 .200" HIGH

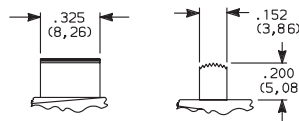

120X models only.

OPTION CODE	ACTUATOR COLOR
2	(STD.) BLACK
1	WHITE
3	RED
7	BLUE
9	GRAY

Other colors available, consult Customer Service Center.

* Subtract .014 (0,36) from actuator height, all models with A, AV2, V3, V4 terminations.

TERMINATIONS

Z (STD.) SOLDER LUG

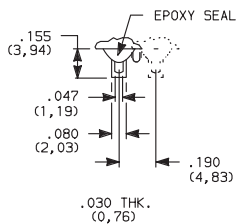

C (STD.) PC THRU-HOLE

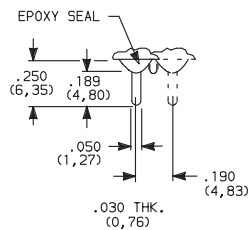

PC MOUNTING

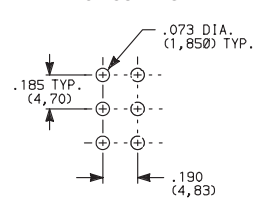

SPDT & DPDT

Not available with K, L or M contact materials.

SPDT & DPDT

Z3 QUICK CONNECT

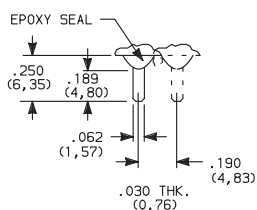

W WIRE WRAP

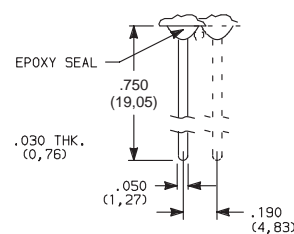

SPDT & DPDT

Not available with K, L or M contact materials.
Mating quick connector available: order part number 530100000, page I-16.

SPDT & DPDT



Third Angle Projection

Dimensions are shown: IN (mm)
Dimensions subject to change



Slide

C&K 1000 Series Miniature Slide Switches

TERMINATIONS

A (STD.) RIGHT ANGLE, PC THRU-HOLE

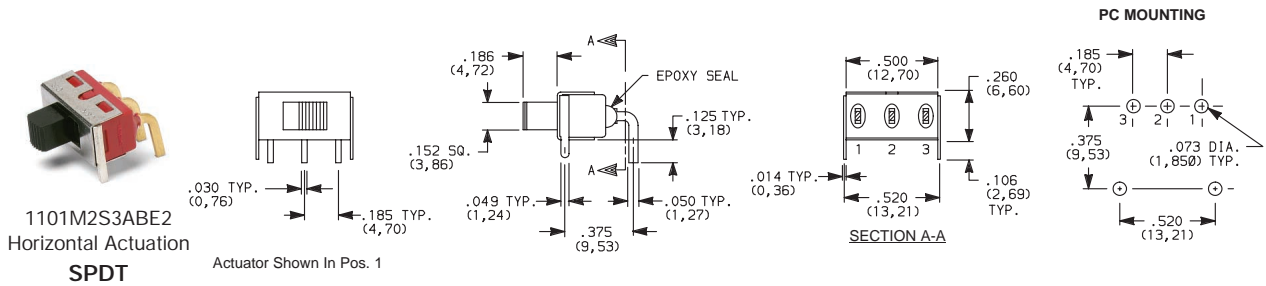

A (STD.) RIGHT ANGLE, PC THRU-HOLE

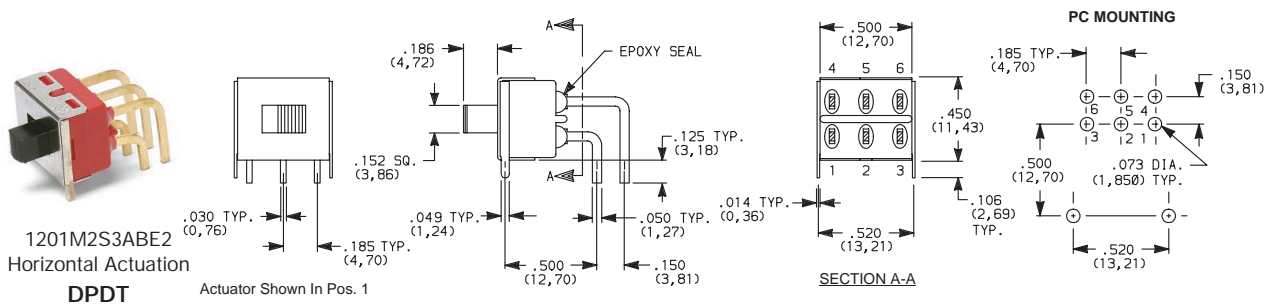

AV2 (STD.) VERTICAL RIGHT ANGLE, PC THRU-HOLE,
.150" PITCH

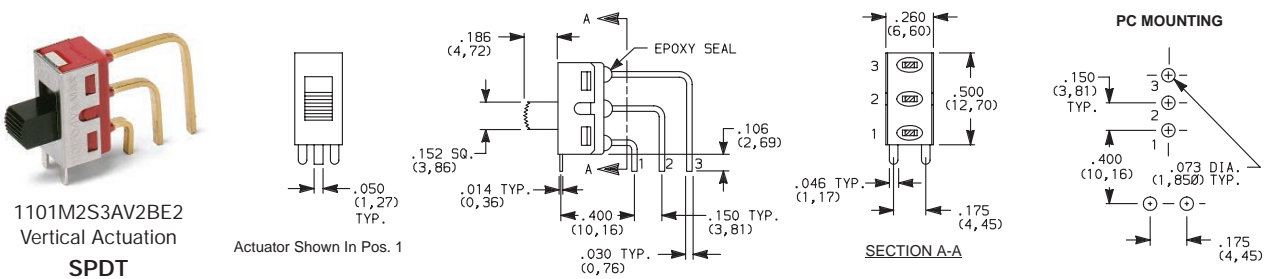

AV4 VERTICAL RIGHT ANGLE, PC THRU-HOLE,
.150" PITCH, EXTENDED

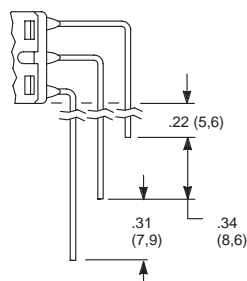

Dimensions are shown: IN (mm)
Dimensions subject to change

www.ittcannon.com

C&K 1000 Series Miniature Slide Switches

TERMINATIONS

AV2 (STD.) VERTICAL RIGHT ANGLE, PC THRU-HOLE, .150" PITCH

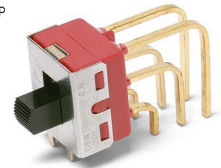
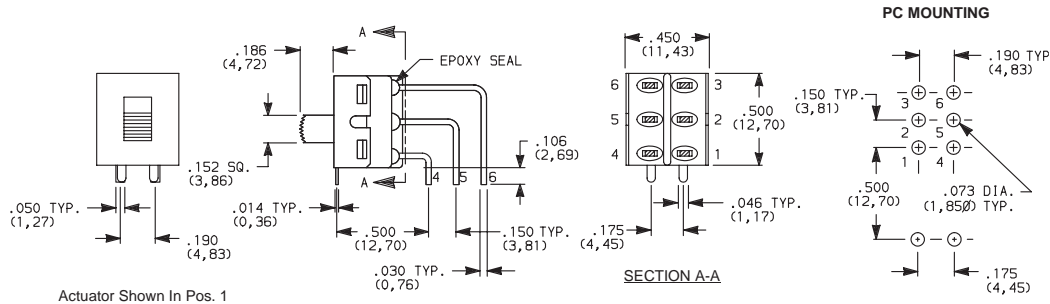

1201M2S3AV2BE2
Vertical Actuation
DPDT

Not available with M1 mounting style, I seal option.
Terminal bend radii and lead-in manufacturing option.

AV4 VERTICAL RIGHT ANGLE, PC THRU-HOLE, .150" PITCH, EXTENDED

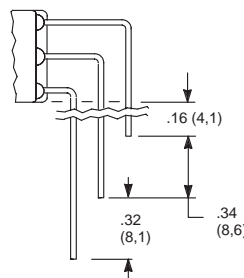

V3, V4 VERTICAL MOUNT, V-BRACKET

OPTION CODE	DIM 'A'
V3	.350 (8,89)
V4	.525 (13,34)

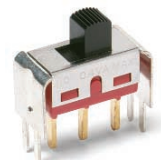
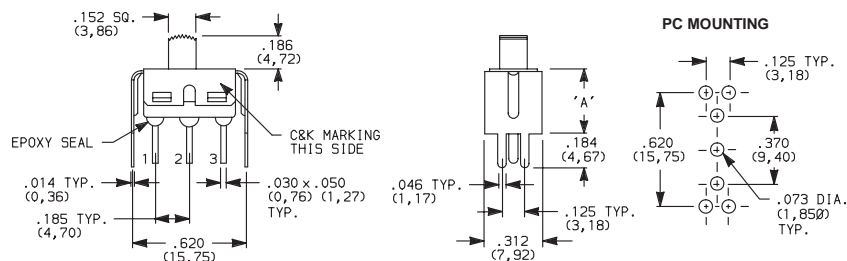

1101M2S3_BE2
SPDT

Not available with
M1 mounting style and I seal.

V3, V4 VERTICAL MOUNT, V-BRACKET

OPTION CODE	DIM 'A'
V3	.400 (10,16)
V4	.575 (14,61)

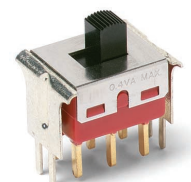
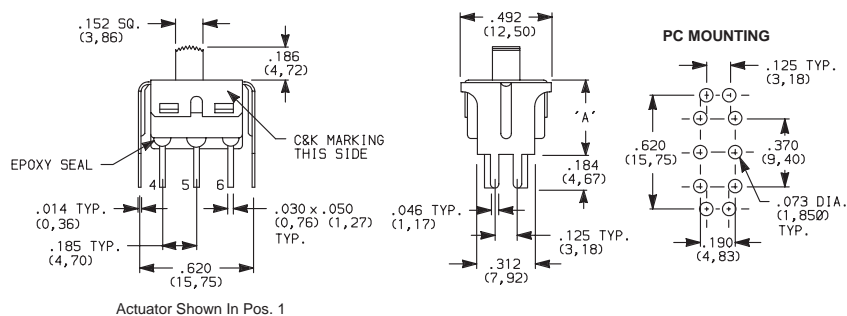

1201M2S3_BE2
DPDT

Not available with
M1 mounting style and I seal.

C&K 1000 Series Miniature Slide Switches

CONTACT MATERIAL

OPTION CODE	CONTACT MATERIAL	TERMINAL PLATING	RATINGS	
B (STD.)	GOLD ¹	GOLD ¹	LOW LEVEL/DRY CIRCUIT	0.4 VA MAX. @ 20 V AC OR DC MAX.
K		TIN-LEAD ⁶		
Q (STD.)	SILVER ^{4,5}	SILVER ⁵	POWER	6 AMPS @ 120 V AC OR 28 V DC; 3 AMPS @ 250 V AC.
M		TIN-LEAD ⁶		
G	GOLD OVER SILVER ^{2,3}	GOLD ³	LOW LEVEL/DRY CIRCUIT OR POWER	0.4 VA MAX @ 20 V AC OR DC MAX OR 6 AMPS @ 120 V AC OR 0.4 MAX. 28 V DC; 3 AMPS @ 250 V AC.
L		TIN-LEAD ⁶		

CONTACT MATERIAL/APPLICATION RECOMMENDATIONS-SEE SECTION N.

¹ CONTACTS & TERMINALS: Copper alloy, with gold plate over nickel plate.

² END CONTACTS: Coin silver, with gold plate over nickel plate.

³ CENTER CONTACTS & ALL TERMINALS: Copper alloy, with gold plate over nickel plate.

⁴ END CONTACTS: Coin silver, silver plated.

⁵ CENTER CONTACT & ALL TERMINALS: Copper alloy, silver plated.

⁶ TERMINALS: Copper alloy, with tin-lead alloy over nickel plate.

All models  with all options when ordered with G, L, M or Q contact material.

B contact material standard with all terminations except C, Z, Z3..

Q contact material standard with C, Z, Z3 terminations.

K, L, M contact materials not available with Z, Z3 terminations.

SEAL

E (STD.) EPOXY SEAL

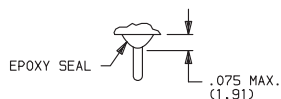

D NO EPOXY SEAL

I EPOXY POTTED BASE

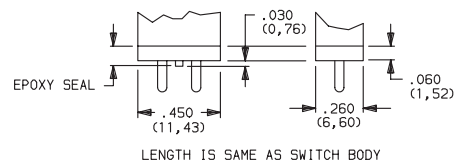

NOTE: Available with C, W, W3, Z, Z3 terminations only.

AVAILABLE HARDWARE

Fits Z3 Termination
female connector



PART NO.

530100000

Available in loose pieces.